

# REAR COIL SPRING

## COMPONENTS

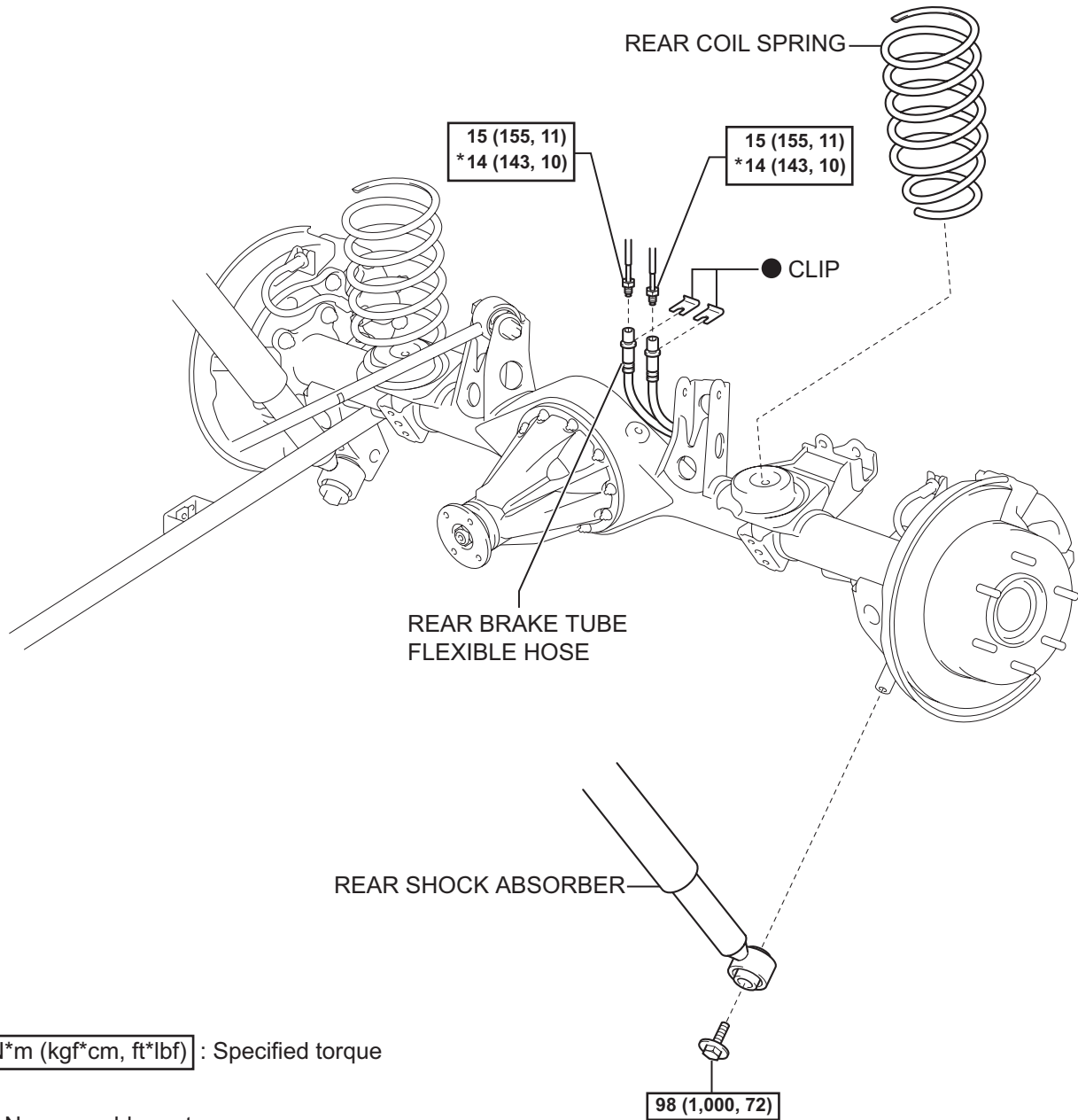

## REMOVAL

1. REMOVE REAR WHEEL
2. SEPARATE REAR SHOCK ABSORBER
  - (a) Support the rear axle housing.
  - (b) Remove the bolt and separate the shock absorber.

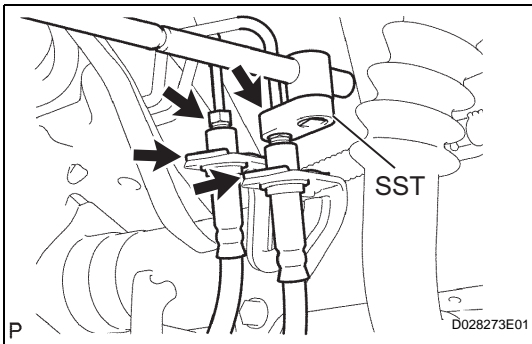
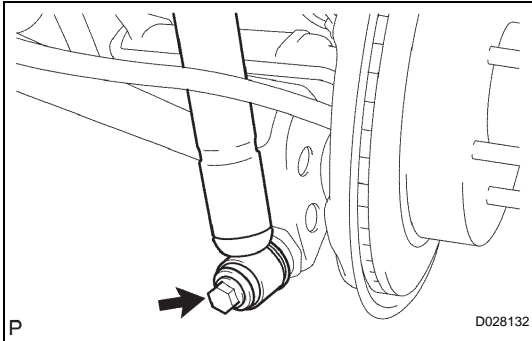

3. SEPARATE REAR BRAKE TUBE FLEXIBLE HOSE
  - (a) Using SST, separate the 2 brake tubes.  
**SST 09023-00101**  
HINT:  
Use a container to catch the brake fluid.
  - (b) Remove the 2 clips and disconnect the 2 flexible hoses.

## 4. REMOVE REAR COIL SPRING

- (a) Start to lower the rear axle housing.  
**NOTICE:**  
**Do not snap the brake line or the parking brake cable.**
- (b) While lowering the rear axle housing, remove the coil spring.

## INSTALLATION

### 1. INSTALL REAR COIL SPRING

- (a) Install the coil spring to the rear axle housing.  
HINT:  
Fit the lower end of the coil spring into the gap of the spring lower seat.

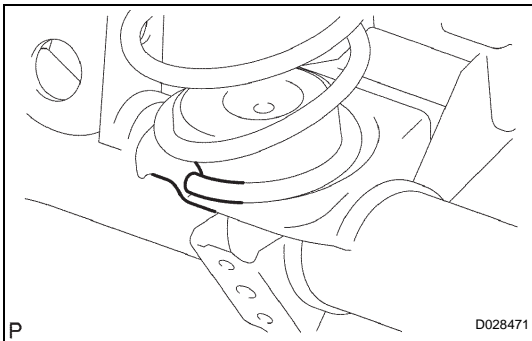

### 2. TEMPORARILY TIGHTEN REAR SHOCK ABSORBER

- (a) Install the shock absorber and temporarily tighten the bolt.

### 3. STABILIZE SUSPENSION

- (a) Jack down the vehicle.
- (b) Bounce the vehicle up and down several times to stabilize the suspension.

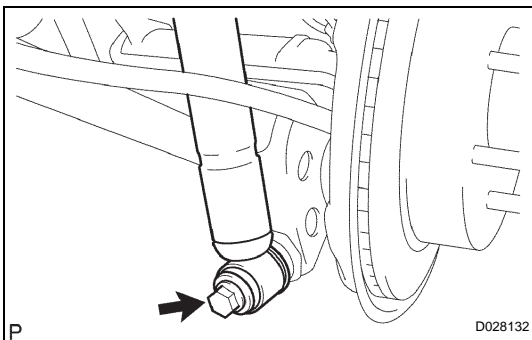

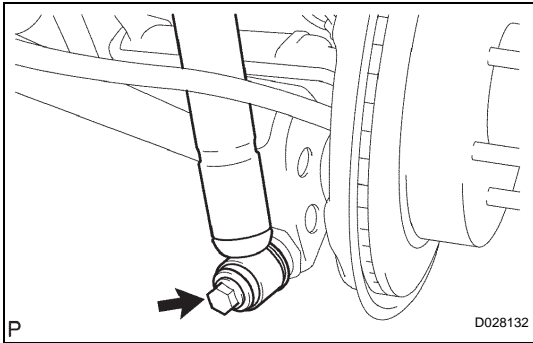

#### 4. FULLY TIGHTEN REAR SHOCK ABSORBER

(a) Fully tighten the bolt.

**Torque: 98 N\*m (1,000 kgf\*cm, 72 ft.\*lbf)**

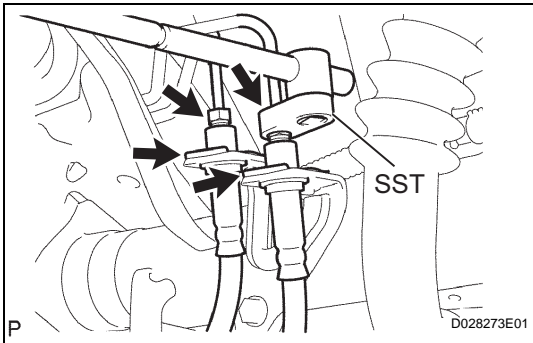

#### 5. INSTALL REAR BRAKE TUBE FLEXIBLE HOSE

(a) Install the 2 flexible hoses with 2 new clips.

(b) Using SST, install the 2 brake tubes onto the flexible hose.

**SST 09023-00101**

**Torque: for use without SST**

**15 N\*m (155 kgf\*cm, 11 ft.\*lbf)**

**for use with SST**

**14 N\*m (143 kgf\*cm, 10 ft.\*lbf)**

**HINT:**

- Use a torque wrench with a fulcrum length of 300 mm (11.81 in.).
- This torque value is effective when SST is parallel to a torque wrench.

#### 6. FILL RESERVOIR WITH BRAKE FLUID (See page [BR-5](#))

#### 7. BLEED BRAKE LINE (See page [BR-5](#))

#### 8. CHECK FLUID LEVEL IN RESERVOIR (See page [BR-7](#))

#### 9. CHECK FOR BRAKE FLUID LEAKAGE

#### 10. INSTALL REAR WHEEL

**Torque: 112 N\*m (1,137 kgf\*cm, 82 ft.\*lbf)**